

SCOTSDALES - GREAT SHELFORD

Proposed Site Plan

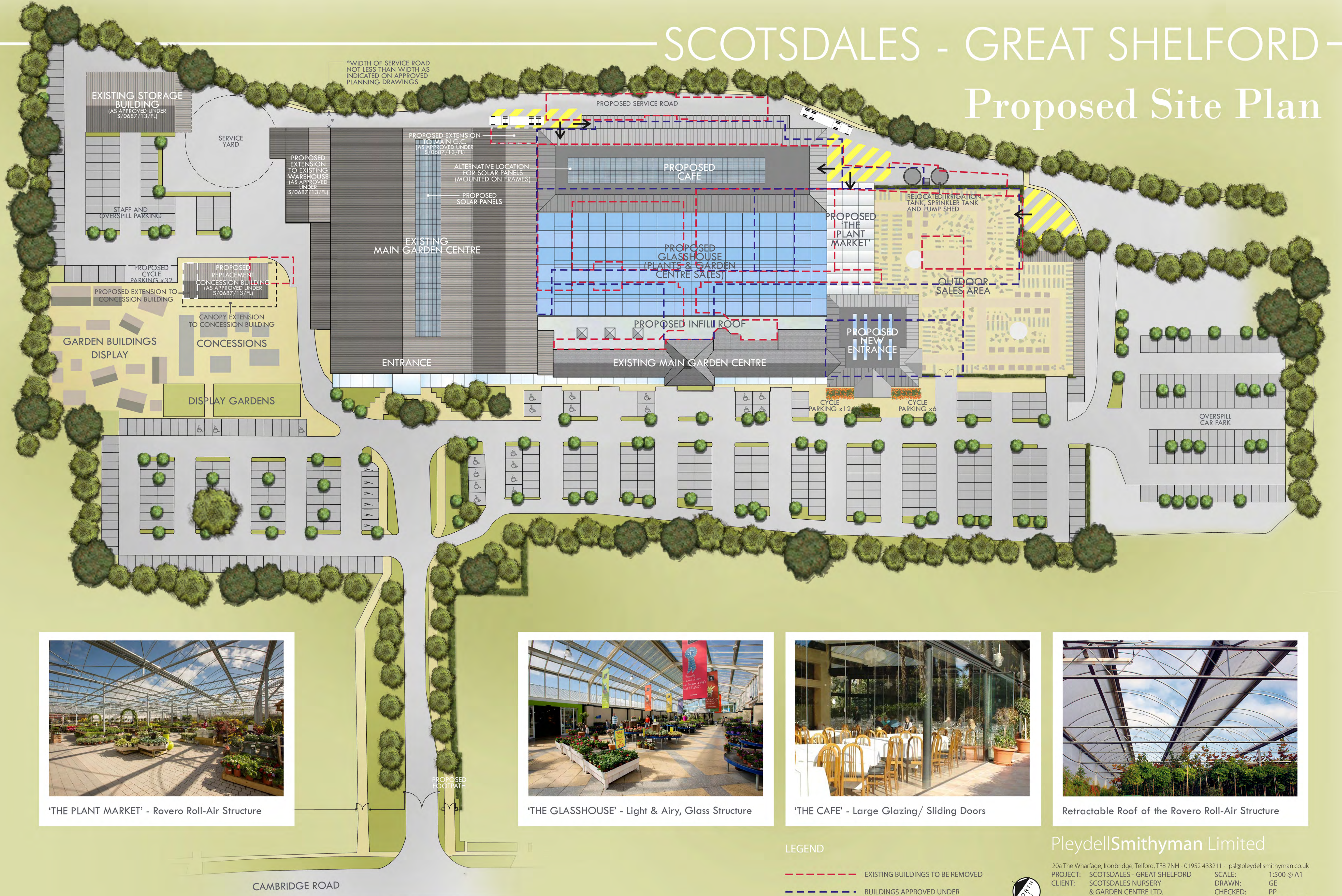

'THE PLANT MARKET' - Rovero Roll-Air Structure



'THE GLASSHOUSE' - Light & Airy, Glass Structure



'THE CAFE' - Large Glazing/ Sliding Doors



Retractable Roof of the Rovero Roll-Air Structure

LEGEND

- - - EXISTING BUILDINGS TO BE REMOVED
- - - BUILDINGS APPROVED UNDER S/0687/13/FL - NOT TO BE BUILT



PleydellSmithyman Limited

20a The Wharfage, Ironbridge, Telford, TF8 7NH - 01952 433211 - psl@pleydellsmithyman.co.uk
 PROJECT: SCOTSDALES - GREAT SHELFORD SCALE: 1:500 @ A1
 CLIENT: SCOTSDALES NURSERY & GARDEN CENTRE LTD. DRAWN: GE
 CHECKED: PP
 TITLE: PROPOSED SITE PLAN DRAWING N°: M13.215.041
 DATE: JUNE 2015 REVISION: H

- A - Notes Added
- B - Store Amended
- C - Disabled Spaces Added
- D - Amendments to Labels
- E - Solar Panels Amended
- F - Service Road Amended
- G - Alternative Solar Panels Added
- H - New Entrance Building Amended