



24/02/2020

Greater Cambridge Shared Planning Policy Team
South Cambridgeshire District Council
Cambourne Business Park
Cambourne
Cambridge
CB23 6EA

Dear Sir/Madam

Call for sites consultation 2020
Land at Little Shelford- Land to North of Church Street

I write on behalf of us as Landowners in support of the completed documentation on this matter. I confirm that we have instructed Bryant Land & Property to complete a submission to South Cambridgeshire District Council on our behalf. The land is available and has potential and should form part of any call for sites and I hope could provide special extension to the village with green benefits much needed in the area. Please note this replaces the submission of 2019 put in by Thakeham Homes

Yours Faithfully

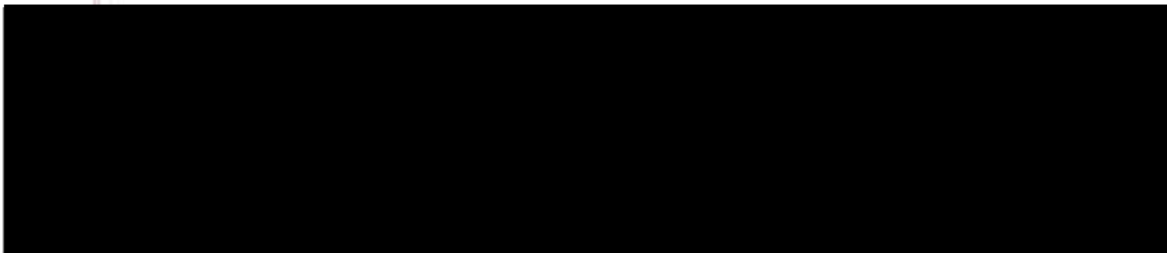

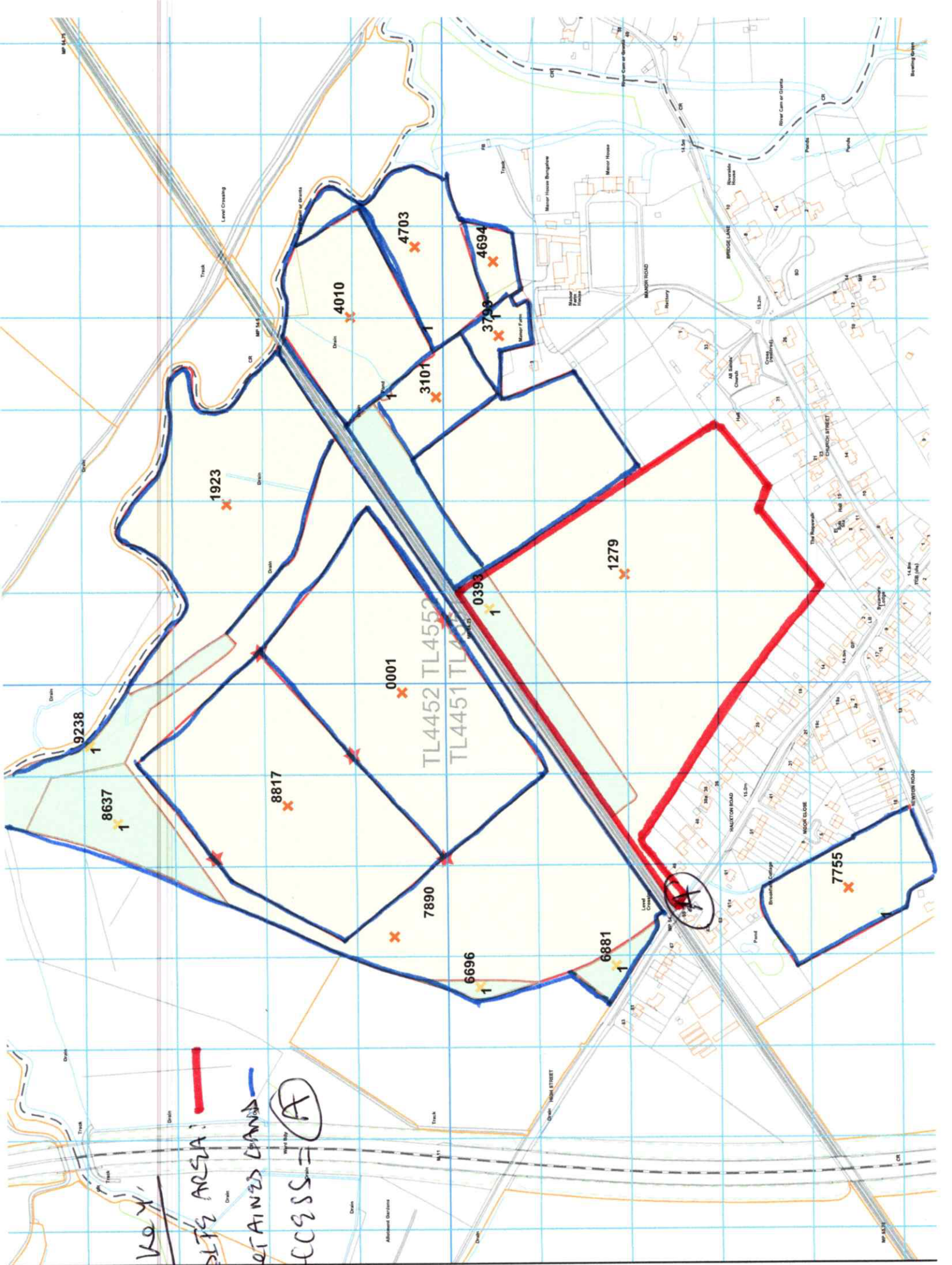

Key

SITE AREA! —

ADJACENT LANDS —

ACCESS = (A)