

Land Adjacent to St George's Way and Woodcock Close, Impington

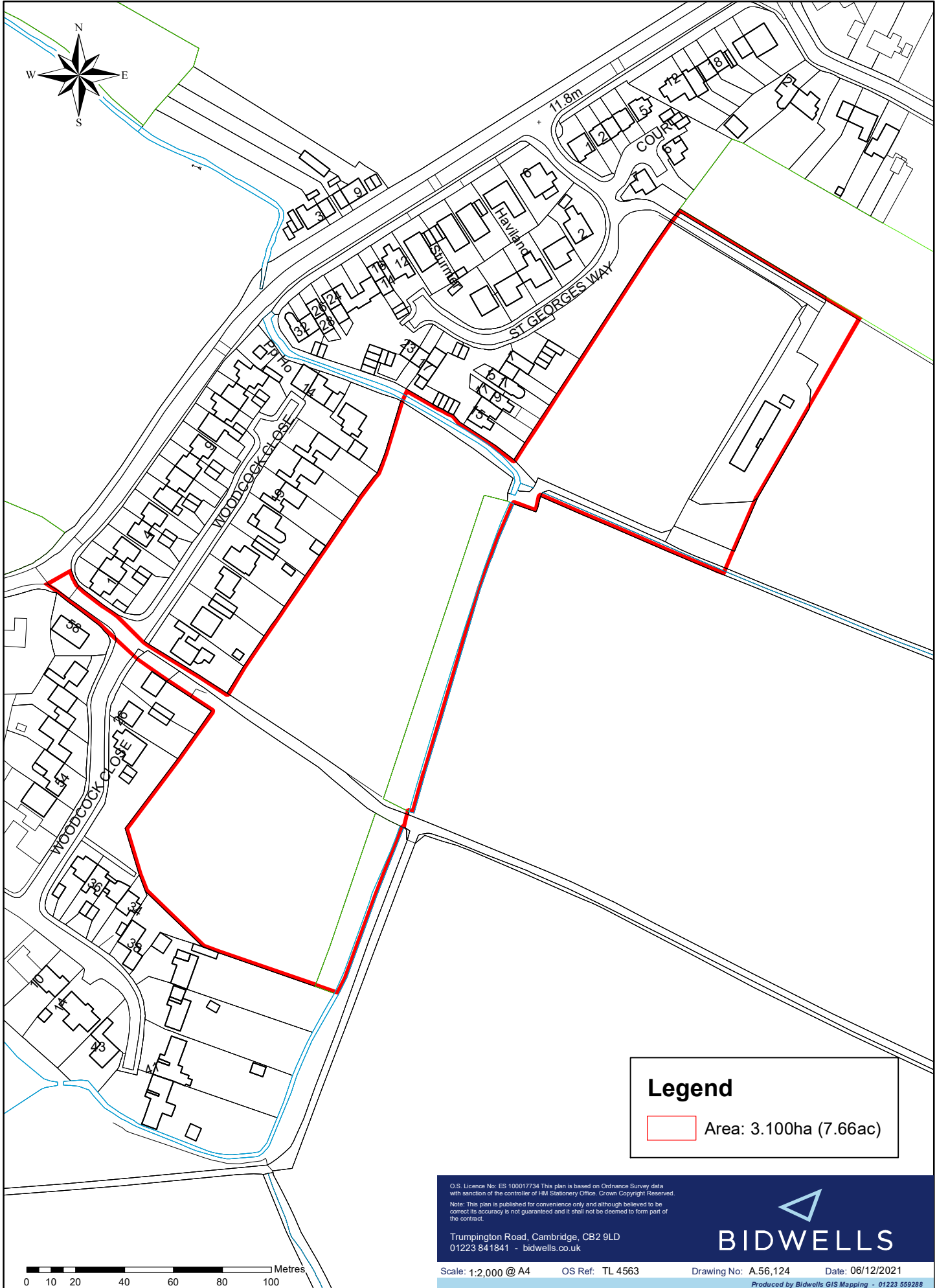

Legend

Area: 3.100ha (7.66ac)

O.S. Licence No. ES 100017734 This plan is based on Ordnance Survey data with sanction of the controller of HM Stationery Office. Crown Copyright Reserved.
Note: This plan is published for convenience only and although believed to be correct its accuracy is not guaranteed and it shall not be deemed to form part of the contract.

Trumpington Road, Cambridge, CB2 9LD
01223 841841 - bidwells.co.uk



BIDWELLS

Scale: 1:2,000 @ A4 OS Ref: TL 4563 Drawing No: A.56,124 Date: 06/12/2021
Produced by Bidwells GIS Mapping - 01223 559288

0 10 20 40 60 80 100 Metres